

DTP DP 4K 330

DISPLAYPORT TWISTED PAIR EXTENDER

DTP
SYSTEMS

4K UHD



DTP T DP 4K 330

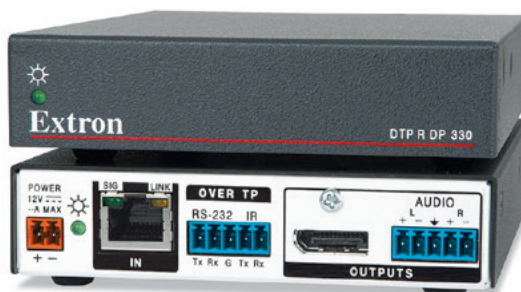

DTP R DP 4K 330

The Extron DTP DP 4K 330 extender sends DisplayPort, analog audio, and bidirectional control signals up to 330 feet (100 meters) over a shielded CATx cable. The HDCP-compliant extender set features a compact enclosure that enables discreet installation in a wide variety of applications.

- ▶ Transmits DisplayPort plus control and analog audio up to 330 feet (100 meters) over a shielded CATx cable
- ▶ Supports computer and video resolutions up to 4K, including 1080p/60 Deep Color
- ▶ Output supports Type 2 dual-mode DisplayPort for interoperability with 4K-capable devices – DTP R DP 4K 330
- ▶ Extron XTP DTP 24 shielded twisted pair cable is strongly recommended for optimal performance
- ▶ DTP™ output is compatible with HDBaseT-enabled devices – DTP T DP 4K 330
- ▶ Accepts additional analog stereo audio signals
- ▶ Bidirectional RS-232 and IR pass-through for AV device control
- ▶ Remote power capability
- ▶ HDCP compliant
- ▶ Supports EDID and HDCP transmission
- ▶ Supports DisplayPort data rates up to 10.8 Gbps
- ▶ Compatible with all DTP 330 Series models and DTP 330-enabled products
- ▶ 1" (2.5 cm) high, quarter rack width metal enclosures
- ▶ Highly reliable, energy-efficient external universal power supply included



Extron Electronics
INTERFACING, SWITCHING AND CONTROL

DESCRIPTION

The Extron **DTP DP 4K 330** is a long distance transmitter and receiver set for sending DisplayPort, audio, and bidirectional RS-232 and IR signals up to 330 feet (100 meters) over a shielded CATx cable to Extron DTP™ 330-enabled products. It provides an effective means of incorporating higher resolution DisplayPort signals with embedded audio into DTP Systems. The DTP DP 4K 330 accepts analog stereo audio signals for simultaneous transmission over the same shielded twisted pair cable. It supports video signals at resolutions up to 4K, including 2560x1600 and 1080p/60 Deep Color. DDC communication of EDID and HDCP is continuously maintained between a source and display, ensuring direct compatibility and optimal signal transmission between devices.

For installation flexibility, the DTP DP 4K 330 transmitter or receiver can be remotely powered over the shielded twisted pair cable by a DTP 330-enabled product. The twisted pair extender also supports simultaneous transmission of bidirectional RS-232 and IR signals from a control system for AV device control. The receiver supports Type 2 dual-mode DisplayPort for HDMI, 4K-capable devices. The transmitter offers an HDBaseT output mode for sending digital video and embedded audio, plus bidirectional control signals to any HDBaseT-enabled display. The DTP DP 4K 330 can be integrated with an Extron DTP CrossPoint® 84 Presentation Matrix Switcher, or other DTP 330-enabled products to support sources, plus displays and other output devices at remote locations.

APPLICATION DIAGRAM

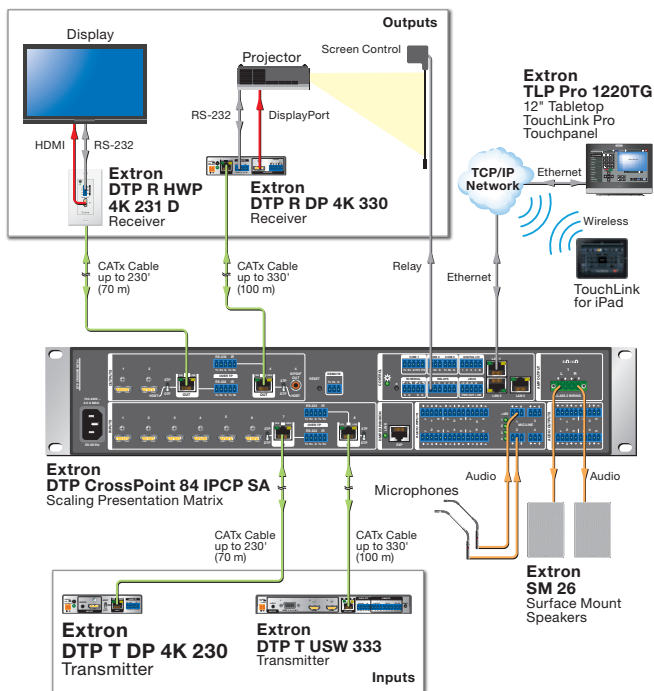

SPECIFICATIONS

TRUE 4K SPECIFICATION

Max. 4K Capabilities		
Resolution and Frame Rate	Chroma Sampling	Max Bit Depth per Color
4096 x 2160 at 30 Hz 3840 x 2160 at 30 Hz	4:4:4	8 bit

Frame Rate ¹	24, 25, 30 fps
Chroma Sampling ¹	4:4:4 or 4:2:2
Color Bit Depth ¹	8 bits per color
Signal Type	DisplayPort, HDCP
Max. video data rate	10.8 Gbps (2.7 Gbps per lane)
NOTE: ¹ Subject to the maximum data rate limit. Use our calculator (http://www.extron.com/product/videotools.aspx) to determine video parameters supported by this data rate.	
NOTE: This product consists of a transmitter (DTP T DP 4K 330) and a receiver (DTP R DP 4K 330), sold separately, with a twisted pair cable linking the transmitter and receiver.	

INTERCONNECTION BETWEEN TRANSMITTER AND RECEIVER

Connector	1 female RJ-45 per unit
Signal transmission distance	
1080p @ 60 Hz	Up to 330' (100 m) using shielded twisted pair (STP) cable or XTP DTP 24 STP cable
2560x1600 @ 60 Hz	Up to 330' (100 m) using shielded twisted pair (STP) cable or XTP DTP 24 STP cable
4K/UHD @ 30Hz and 60 Hz	Up to 330' (100 m) using shielded twisted pair (STP) cable or XTP DTP 24 STP cable
Cable requirements	Solid conductor, 24 AWG or better
Cable recommendations	400 MHz bandwidth, STP (shielded twisted pair)
NOTE: Extron XTP DTP 24 shielded twisted pair cable is strongly recommended for optimal performance.	
NOTE: Input and output mode signaling:	
DTP: HDMI with embedded audio, analog audio, RS-232 and IR, and remote power	
HDBaseT: HDMI with embedded audio plus RS-232 and IR	

AUDIO INPUT

Signal type	
Analog audio (over DTP)	Stereo (2 channel), balanced/unbalanced
NOTE: Analog audio is not embedded onto the DisplayPort signal. Embedded digital audio is not de-embedded from the DisplayPort signal.	

COMMUNICATIONS – external device (pass-through, unidirectional or bidirectional)

Serial control port input/output	
Transmitter	RS-232 via (1) 3.5 mm, 5 pole captive screw connector for RS-232 control (±5 V) (connector is shared with IR control port)
Serial control port output/input	
Receiver	RS-232 via a 3.5 mm, 3 pole captive screw connector

GENERAL

Power supply	External
	Input: 100-240 VAC, 50-60 Hz
	Output: 12 VDC, 1 A, 12 watts

Model	Version Description	Part number
DTP T DP 4K 330	DisplayPort Tx - 330 feet (100 m)	60-1076-52
DTP R DP 4K 330	DisplayPort Rx - 330 feet (100 m)	60-1076-53

For complete specifications, please go to www.extron.com
Specifications are subject to change without notice.

WORLDWIDE SALES OFFICES

Anaheim • Raleigh • Silicon Valley • Dallas • New York • Washington, DC • Toronto • Mexico City • Paris • London • Frankfurt
Madrid • Stockholm • Amersfoort • Moscow • Dubai • Johannesburg • Tel Aviv • Sydney • Melbourne
New Delhi • Bangalore • Singapore • Seoul • Shanghai • Beijing • Hong Kong • Tokyo

www.extron.com